

PINION SHAFT & CROWN WHEEL GEAR		
Gear Profile Data	Abbreviation	Value
Twist Angle	Beta	15°
Pressure Angle	Alpha	20°
Normal Modul	Mn	4.217
Number of Teeth Pinion	Z ₁	24
Number of Teeth Crown Wheel	Z ₂	57

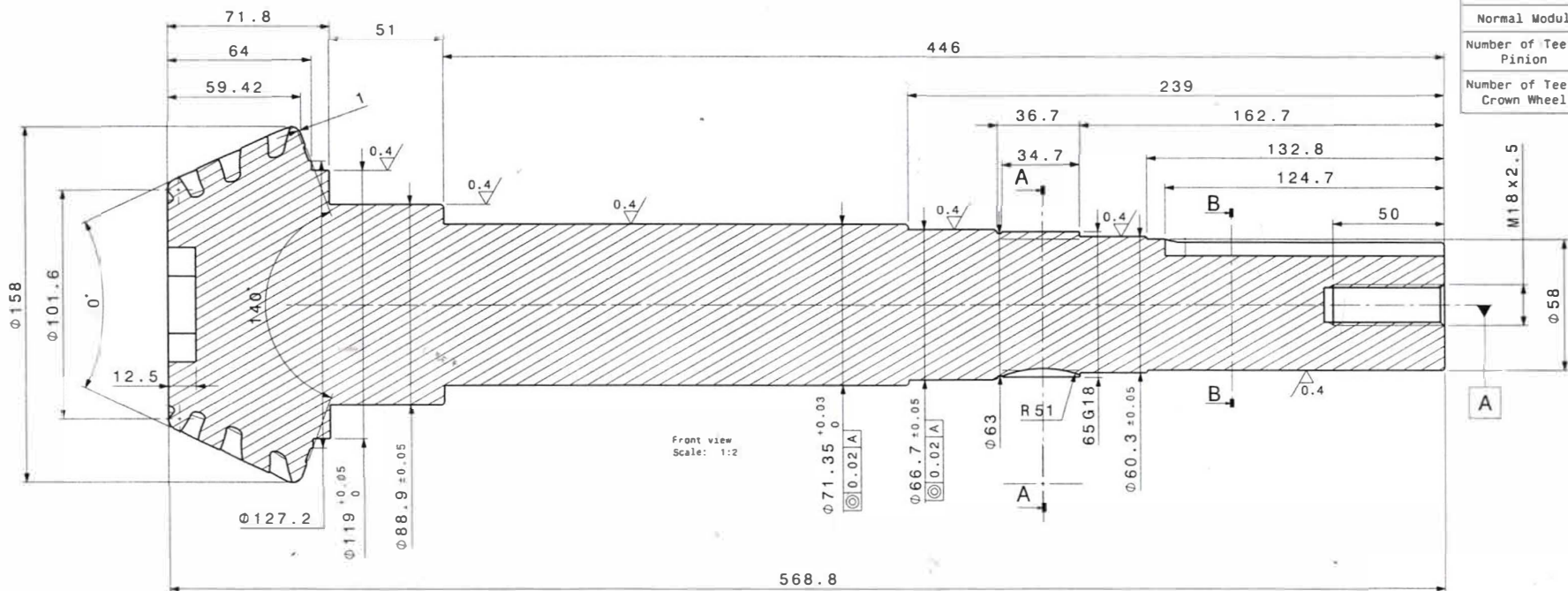

Note:

- Material and treatment:**
- Material no. 1.6523 (20CrNiMo2-2)
 - Alternative materials acc. to DIN EN 10084:
 - 1-Material no. 1.6587 (18CrNiMo 7-6)
 - 2-Material no. 1.6566 (17NiCrMo 6-4)
 - 3-Material no. 1.6657 (14NiCrMo 13-4)
 - Material composition, treatment and mechanical specification acc. to DIN EN 10084
 - Material quality grade MQ acc. to ISO 6336-5
 - Hardness of surface: 600:50HV
 - case hardening depth: 0.2:0.1
 - Core hardness: 350:50HV

- General standard:**
- Unspecified tolerance acc. to ISO 2768-f
 - Surface textures acc. to ISO 1302
 - Geometrical tolerance acc. to DIN ISO 1101
 - Tolerancing DIN 7167 (envelope principles)
 - Remove all burrs and sharp edges

Lapping Gear: 3 Hours

Standard ISO 2768-1							
Tolerance class	0.5 to 3	3 to 6	6 to 30	30 to 120	120 to 400	400 to 1000	1000 to 2000 to 4000
f	±0.05	±0.05	±0.1	±0.15	±0.2	±0.3	±0.5
m	±0.1	±0.1	±0.2	±0.3	±0.5	±0.8	±1.2

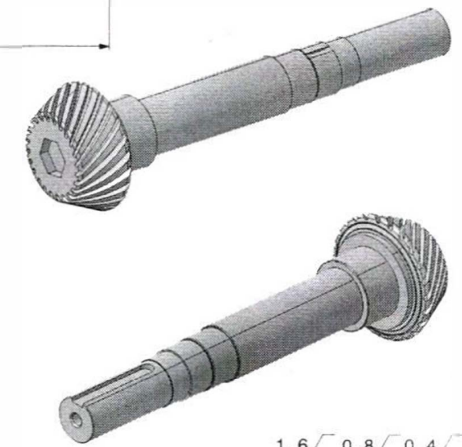
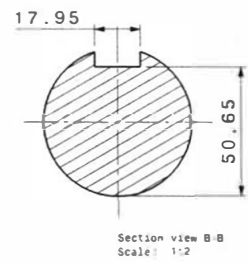
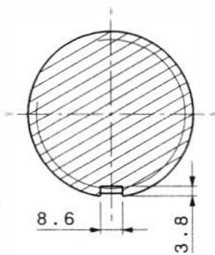
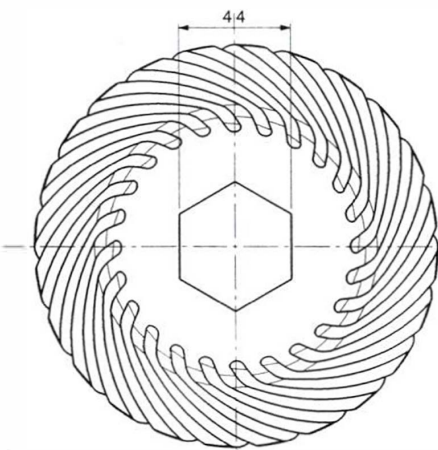

General Tolerance	Material: 1.6523		Code Kala: 6602112517	
	NAME & SIGN.	DATE		
	DIM.: ISO 2768-1/f	DR. J.Alishan	96-08	Part Name: Pinion Shaft Gear
GEO.: ISO 2768-2/H	CHE. M.Bahaeddini	96-08		
SHEET SIZE: A3	SCALE: 1:4	WEIGHT- 22g	QTY:	Project Title: Cooling Tower